



### Key Features

- Use Hisilicon chip, mini version of Linux, high stability;
- Low power consumption (down to 4W);
- Support for multiple types of shells, custom appearance
- High-precision face recognition algorithm;
- Embedded algorithm, millisecond comparison;
- Accurate monocular live detection, safe and efficient;
- The accuracy rate of N library is less than 50,000, reaching 99.8%;
- Multi-scene image exposure and correction algorithm;
- Support temperature measurement, display, high temperature warning
- Support temperature interface protocol;
- Support mask reminder.

### Applicable scene

Suitable for parks, communities, communities, campuses, etc.

### Technical Parameters

Technical Parameters	
Operating system	Embedded Linux
RAM	DDR3 8GB
Storage	Built-in 8GB as standard, 128GB can be expanded by TF card
Display	7 "HD IPS display
Monocular camera	200W pixels, 120-degree wide-angle lens, support wide dynamic, white light night vision
Door opening method	Support face recognition
Opening hours	<0.3 seconds (30,000 bases)
Face recognition rate	99.8%
Minimum pixel	Face recognition supports minimum face pupil distance of 20 pixels
Face library capacity	Support up to 50,000
Black/White list function	Support
General parameters	
Network	1 RJ45 100M Ethernet port
Communication mode	Support TCP / IP wired communication
Power supply	DC 9~18V/3A,4W
Work temperature	-35℃~75℃

Installation characteristics	Installation and use of supporting gates / speed doors
Custom services	Appearance can be customized, customization is chargeable
<b>Temperature measurement module parameters</b>	
Temperature measurement distance	<1m
Best distance	0.5-0.8m
Temperature measurement accuracy	±0.3
Temperature measurement range	-40-85℃
Effective emissivity	0.97±0.02
Wavelength size	5.5-14um
Corresponding time	<1second

**Dimension**(Unit: mm )

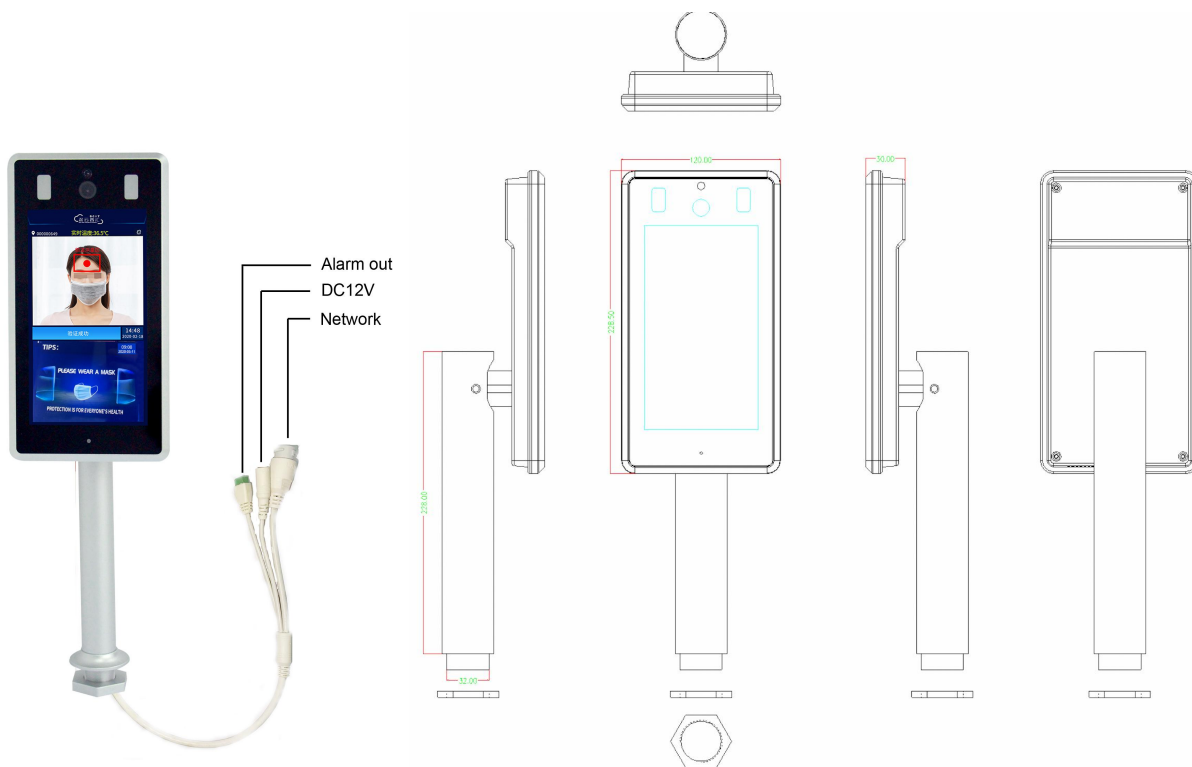

**Precautions:**

1. The temperature measuring equipment should be used in a room with a room temperature of 10 degrees Celsius to 40 degrees Celsius. Do not install the temperature measuring equipment to the vent, and ensure that there is no heating source within 3 meters;
2. People entering the room from a cold outdoor environment will affect the temperature measurement accuracy, and the forehead temperature test needs to be performed indoors for three minutes without covering the forehead and the temperature is stable;
3. The temperature read by the temperature measuring device is the temperature in the forehead area. When there is water, sweat, oil or thick makeup on the forehead or the elderly have more wrinkles, the read temperature will be lower than the actual temperature, and ensure there is no hair or clothing in the area.